

Tanny's  
**comcentre**





Tanny Shelters is the leading independent housing solution provider operating in key hubs across Coimbatore.

Tanny Shelters comes up with exceptional designs and utilizes cutting-edge technologies with best practices for every construction that we offer, along with a sustainable approach. We better understand evolving urban lifestyles as well as needs, and design intelligent spaces to fulfil the aspirations of new-age customers.

Established in 2012, the company has developed over three lakh sq.ft of real estate, and has completed multiple projects across Coimbatore city, namely Tanny's Businestle, Tanny's- Green Springs, Tanny's Smile Stone, Tanny's B-Enclave, Tanny's Seyon Ville , Tanny's Skanda Homes, Tanny's Ve'Lands in prime locations.





# Smart Workspace Solutions For Your Future

Tanny's Comcentre is a commercial project developed by Tanny Shelters. This project offers well designed corporate space and offices at very affordable prices. The site is situated in Bharathi Park, Saibaba Colony and is well connected to all parts of the city with transportation and has close proximity to all civic utilities. The project is well equipped with all modern amenities and 24X7 security service to facilitate every business needs. Read on and explore your new office space at Tanny's Comcentre.



STILT FLOOR PLAN

Name	Sale Area (SFT)
Office 1	741
Office 2	690
Office 3	717
Office 4	1294
Office 5	427
Total	3869

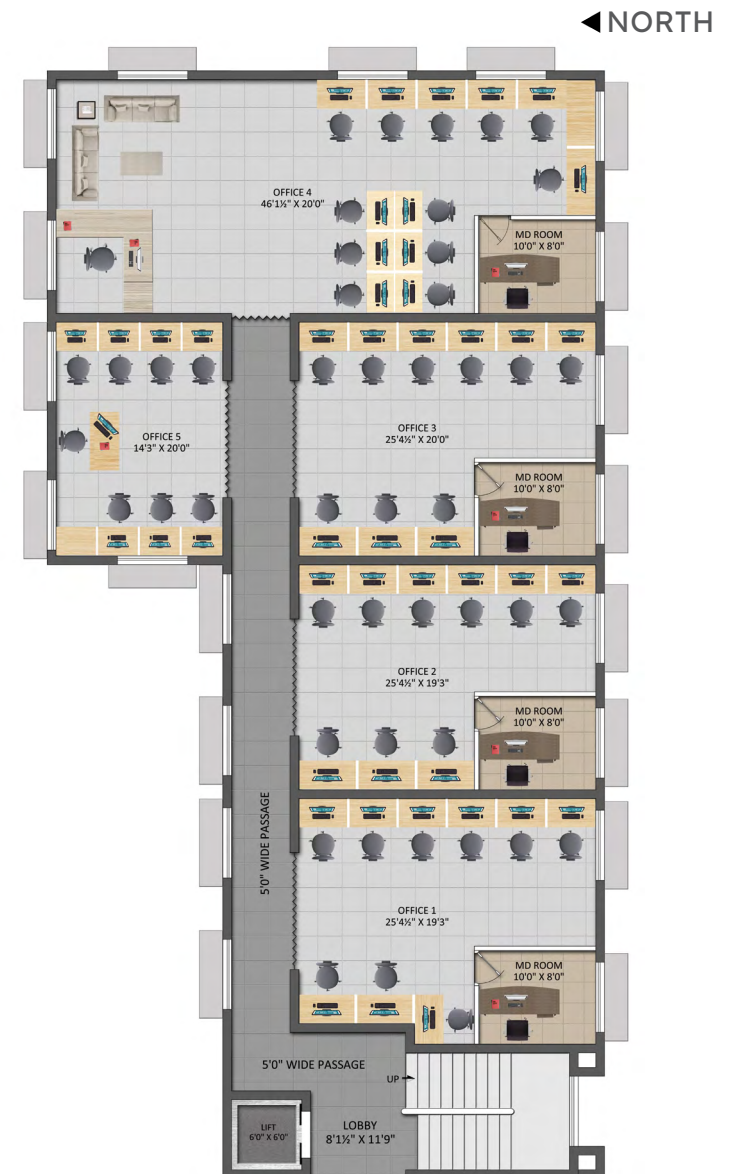

TYPICAL FLOOR PLAN



## TANNY'S COMCENTRE - FEATURES



COMPREHENSIVE  
BUILDING  
MAINTENANCE BY  
DEDICATED TEAMS



HI-TECH  
AUTOMATED  
ELEVATOR



FULLY COVERED  
TWO-WHEELER &  
FOUR-WHEELER  
PARKING FACILITY



POWER BACK-UP  
FOR COMMON  
AREAS &  
ELEVATOR



EXCLUSIVE  
500W POWER  
BACK-UP FOR  
ALL OFFICES



ATTACHED  
INDIVIDUAL  
REST ROOMS FOR  
ALL OFFICES



INTERIOR  
DESIGNING FOR  
OFFICE SPACES  
(OPTIONAL)



RAIN WATER  
HARVESTING  
SYSTEM



ECO-FRIENDLY  
AMBIENCE



24X7 SECURITY



CAFETERIA  
(OPTIONAL)

# TANNY'S COMCENTRE - SPECIFICATIONS

## STRUCTURE

- R.C.C Framed Structure, Good Quality Brick Masonry Construction.

## JOINERIES

- Entrance Door: Toughened Glass Door with Safety Shutters.
- Windows & Ventilators: UPVC Windows, Heat Proof Structural Glazing for Outdoors, Elevation.

## FLOORING AND WALL TILES

- Lobby, Lift and Staircase - Good Quality Granite/Tile Flooring.
- Toilet: Matt Ceramic Tile Flooring, Glazed Ceramic Tile Going Upto 7" 0' ht of Reputed Brand.
- All Other Office Spaces: Vitrified Tile Flooring.

## LIFT AND STAIRCASE

- 1 No. of 8 Passenger Lift. 1 No. of Spacious Staircase of Good Quality Granite Flooring with SS Handrail.

## CP FIXTURES & SANITARY FIXTURES

- ISI Certified Brands for Water Line Arrangements.
- EWC & Wash Basin of Hindware/Parryware Make.
- All Taps are of Basic Type Jaguar Make.
- Underground Sump & Overhead Tank of Suitable Capacity.

## PAINTING AND POLISHING

- Internal Walls & Ceiling: Finished with 2 Coats of Pop, 1 Coat of Primer & 2 Coats of Emulsion Paint.
- External Walls: Finished with 1 Coat of White Cement And 2 Coats of Exterior Grade Emulsion Paint.
- Grills: Painted with Enamel Paint.

## ELECTRICALS

- Finolex Wires or Equivalent Brand Wires of Suitable Gauge.
- Modular Plate Type Control Switches and Sockets. Supply Through a Distribution Board Incorporating MCB Made of Legrand.

## WATER SUPPLY

Adequate Storage upto Sump Provided for Borewell and Drinking Water.

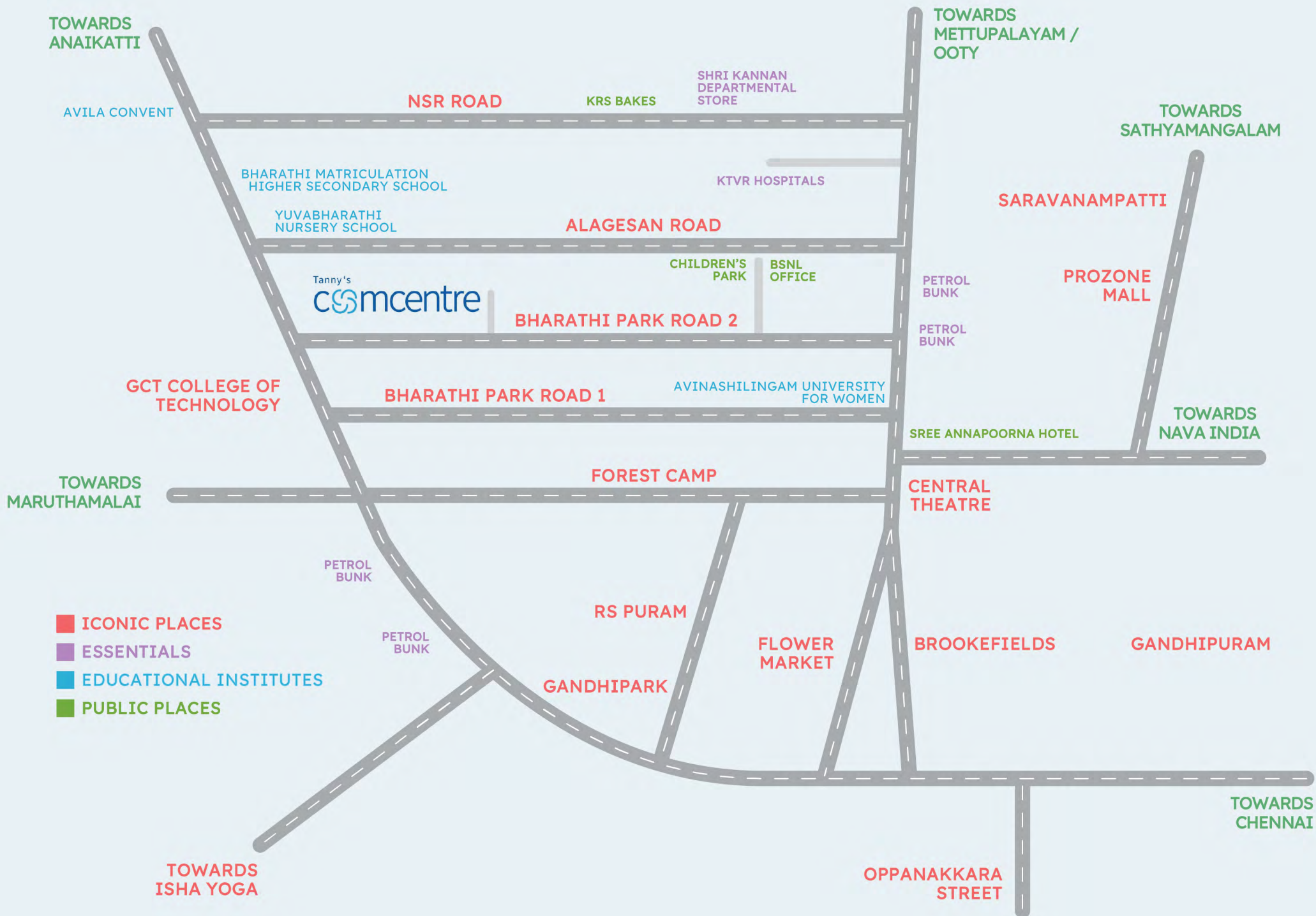



## Tanny Shelters Private Limited

Old No-42, New No-64, Ground Floor,  
Ramalinga Nagar, Saibaba Colony,  
Coimbatore- 641011 Tamil Nadu, INDIA.

[www.tannyshelters.in](http://www.tannyshelters.in)

Tanny's  
**GREEN SPRINGS**  
A DREAM OF YOURS..  
Saravanampatti

Tanny's  
**Businestle**  
100 ft. Road, Gandhipuram

Tanny's  
**Seyon Ville**  
GN Mills

Tanny's  
**B Enclave**  
V.K.K. Menon road, New Sidhapudur

Tanny's  
**SmileStone**  
Saravanampatti

Tanny's  
**Ve'Land's**

Tanny's  
**Skanda  
Homes**  
Saravanampatti

Disclaimer: The amenities, specifications, facilities, surrounding infrastructure, stock images and features shown and/or mentioned and the image renders used herein are purely indicative and for representational purposes and may differ from the actuals. Photographs of interiors, surroundings or location are digitally enhanced unless otherwise mentioned. Not all photos may have been shot at site. Products, features, light fittings, pictures, images, etc. shown as illustrations are for reference only. The colours, shades of walls, tiles etc. shown in the images are for the purpose of representation only and may vary upon actual construction. All images, the interiors and furniture items displayed therein are to give a perspective to the customer and are not part of the flat to be sold to the customer.

All dimensions mentioned in the drawings may vary/differ due to construction contingencies and site conditions. Actual product/ development and any other aspect may differ from what is portrayed herein. All layouts, plans, specifications, dimensions, designs, measurements and locations are indicative and not to scale and are subject to change as may be decided by the company or competent authority. Revision, alteration, modification, addition, deletion, substitution or recast, if any, may be necessary during construction.